

- NOTES:
1. ALL DRAWINGS TO BE CHECKED BY CONTRACTOR ON SITE AND ENGINEER INFORMED OF DISCREPANCIES BEFORE WORK COMMENCES
 2. ALL LEVELS ARE IN METRES AND ARE RELATED TO ORDNANCE DATUM
 3. CONTRACTOR SHALL SATISFY HIMSELF AS TO THE ACCURACY OF PAVEMENT LEVELS ON SITE PRIOR TO COMMENCEMENT OF WORKS ON SITE
 4. ALL SURFACE WATER SEWERS TO BE CLASS H CONCRETE TO EN1916 & IS 6 2004.

SERVICES LEGEND

	S4-1 IL 60.0	SURFACE WATER SEWER
	IL 58.6	SURFACE WATER COLLECTOR DRAIN
		SURFACE WATER FILTER DRAIN
		PERMEABLE PAVING
	R6	ROAD GULLY
	(57.15)	ROAD LEVEL
	1:20	ROAD GRADIENT
	F5 IL 17.21	EXISTING FOUL SEWER
	S10 IL 16.45	EXISTING SURFACE WATER SEWER
	(12.93)	AS-BUILT ROAD LEVEL
		PROPOSED SITE BOUNDARY

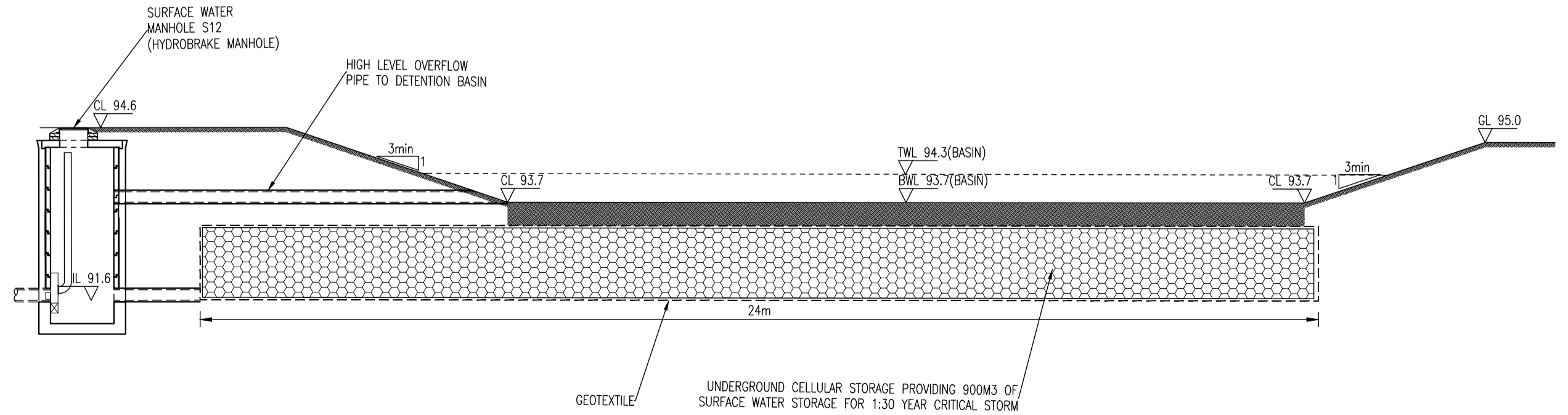
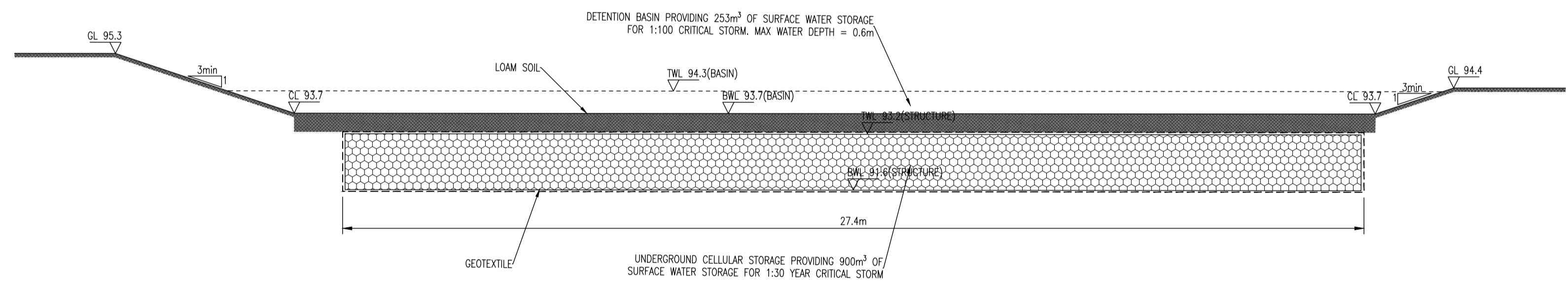
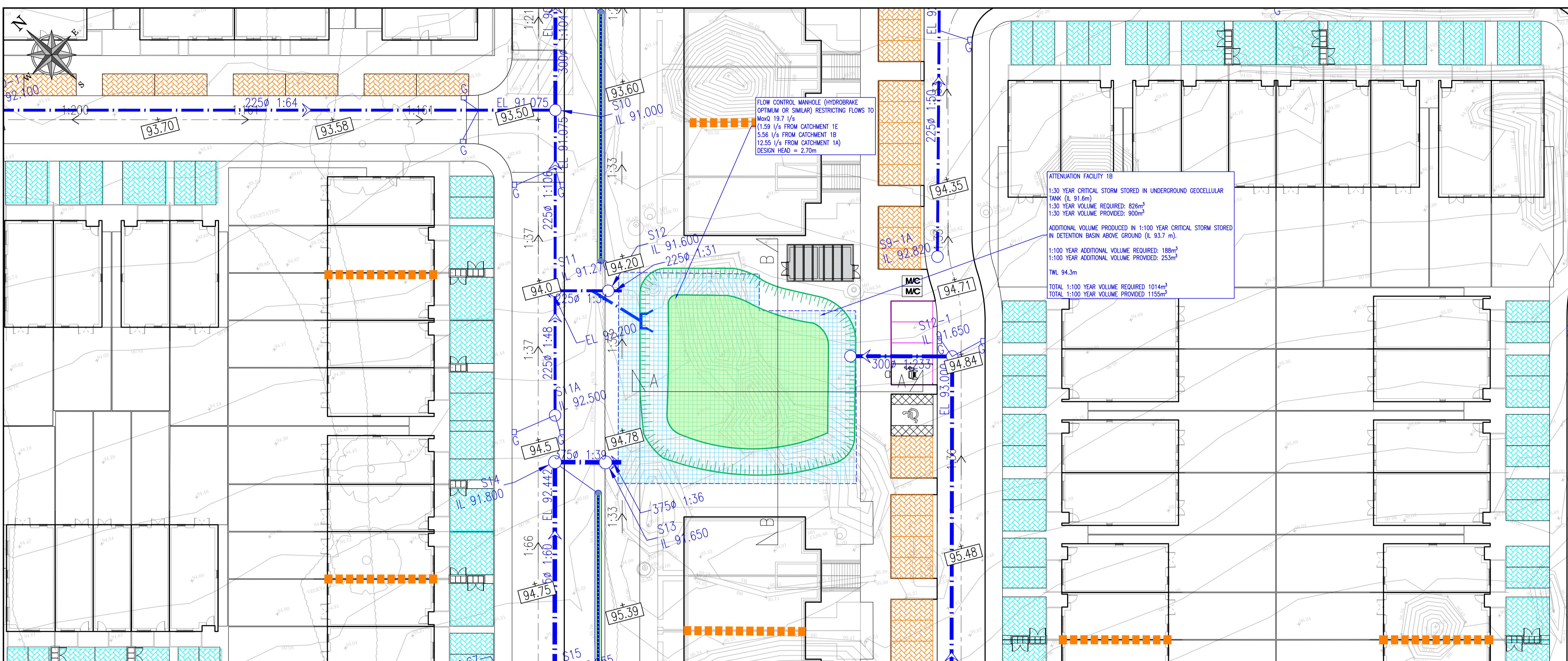

REV	DATE	DESCRIPTION	BY	CHKD
PLANNING				
DESIGNED	NGC	PREPARED	PJC	
DATE	SEP 2019	CHECKED	DJR	

DBFL CONSULTING ENGINEERS

DUBLIN OFFICE: Ormrod House, Upper Ormrod Quay, Dublin 7, Ireland. PHONE: +353 1 400 4000 FAX: +353 1 400 4050

WATERFORD OFFICE: Unit 2, The Chandlery, 1-2 O'Connell Street, Waterford, Ireland. PHONE: +353 51 308 500 FAX: +353 51 844 913

DBFL Consulting Engineers email: info@dbfl.ie site: www.dbfl.ie

PROJECT
LANDS AT NEWCASTLE, SOUTH DUBLIN

DRG. TITLE
ATTENUATION 1B FACILITY

ARCHITECT
MOLA

SCALE	AS SHOWN @A1	FILE REF.	170024-3021
DRG. NO.	170024-3022		